

AMERICA IS BUILT

ON NEENAH

DETECTABLE  
WARNING  
PLATES

MADE IN USA

NEENAH  
FOUNDRY **NE**



Since Neenah Foundry opened in 1872, we've learned a lot about what it takes to create products that stand the test of time.

There's a reason you see Neenah products in cities all across the USA—it's because we build them to last. Our Detectable Warning Plates are customizable to your job with trouble-free installation, premium materials, a multitude of options to fit the job and a 5-year warranty.

The only thing more durable than our cast iron is our determination to produce high-quality products worthy of the cities they serve.

Our well-balanced line of Detectable Warning Plates aren't just made in America—they make America.

Because America is Built on Neenah.

## Withstands the Harshest of Weather Conditions

Our cast iron Detectable Warning Plates are regulatory-compliant while offering appealing aesthetics, exceptional longevity and freedom from maintenance. No matter where they're placed, you can be confident Neenah DWP's will stand strong in any climate.

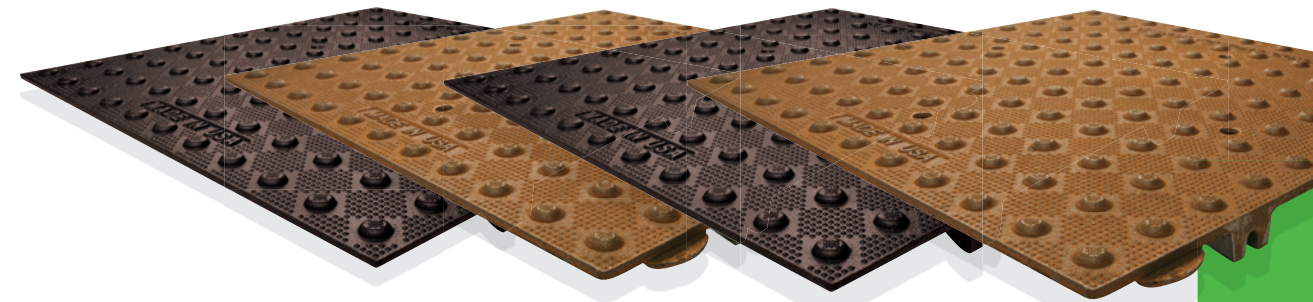

## Neenah's Detectable Warning Plates Offer



### Exceptional Durability

- Combine the durability of cast iron with its ability to adhere to concrete
- Eliminate maintenance problems associated with the wearing, peeling, cracking, and delaminating of non-iron materials



### Aesthetic Appeal

- Recommended to be furnished and installed in their natural unpainted state for best long-term, maintenance-free performance and aesthetic appeal
- Unpainted plates will develop a permanent patina that remains the same throughout their lifetime
- Powder coat paint is available upon request in a variety of colors including federal yellow, black, and brick red



### Superior Performance

- The durability of cast iron even withstands snow plow abuse
- They'll look brand new for years to come
- The most durable, long-term product available



### Simple Installation

- Installs into prepared concrete in minutes
- Reusable lifting springs simplify the installation process



### Specifications

- Qualified design professionals can use Neenah's Detectable Warning Plates in their plans to meet current ADA and ABA guidelines

## The Benefit of Unpainted Plates

Upon exposure to moisture, cast iron plates form a temporary iron oxide scale before darkening to a patina, which is permanent throughout the life of the installation. Look at manhole covers in the street to see how the color matures.

## Coefficient of Friction

Excellent non-skid characteristics comply with all ADA and ABA guidelines. The measured coefficient of friction is 0.9.



# Features & Benefits

Every Detectable Warning Plate from Neenah is built with lasting form and function. Installations with natural finish are maintenance-free and highly resistant to damage. Our DWP's are non-skid and have excellent adhesion properties with no need for replacement features. Installation is simple—vent holes release trapped air for maximum concrete contact and adhesion, and furnished lifting brackets further simplify the process. They fit in any space, with both radius and straight sections available. All Neenah DWP's come with a 5-year limited warranty.

## Quick Connect Plates

Catalog Number	Depth	Width
4984-24Q	24"	24"
4984-30Q	24"	30"
4984-36Q	24"	36"

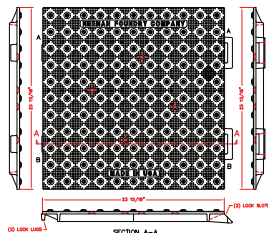

## Bolted Plates

Catalog Number	Depth	Width
4984-24B	24"	24"
4984-30B	24"	30"
4984-36B	24"	36"
4984-12B	24"	12"

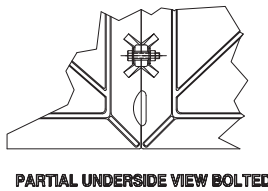

## Radius Plates

Catalog Number	Depth	Width
4984-9-5R	24"	9' 5"
4984-15R	24"	15'
4984-20R	24"	20'
4984-25R	24"	25'
4984-35R	24"	35'
4984-6R	24"	6'
4984-8R	24"	8'

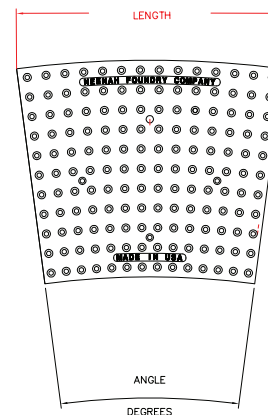

# Technical Features

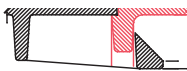

Precision casting provides level seaming between plates

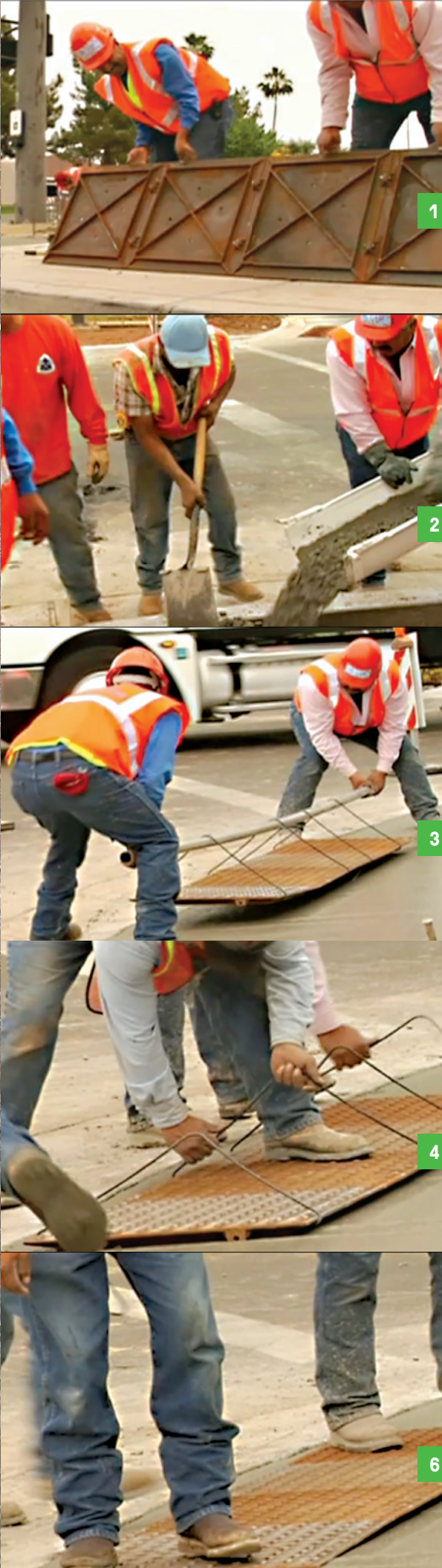
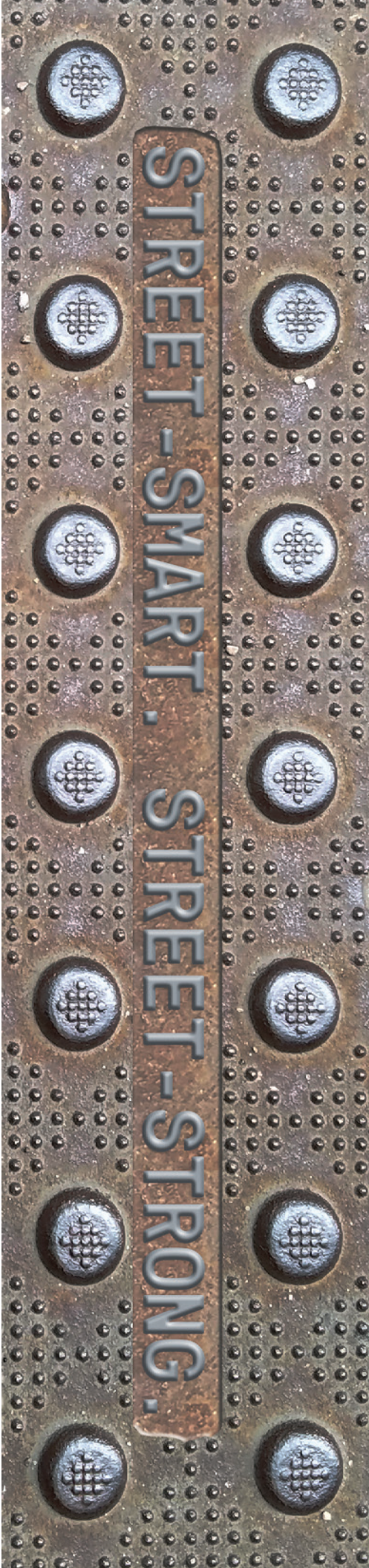
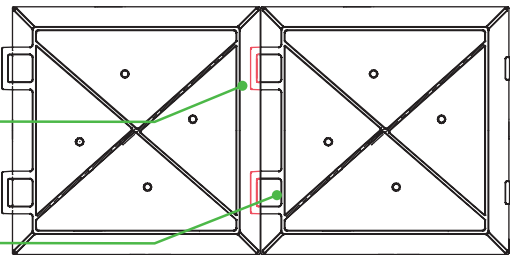

# Installation

Installing Neenah Foundry Detectable Warning Plates is quick and easy. In just a few minutes, you can install the plates in any number of configurations.

# Installation Steps

- 1 If necessary, connect multiple plates together.
- 2 Pour concrete.
- 3 Use supplied lifting springs and a construction 2x4 or pipe to lift plates into position.
- 4 Set plates in wet concrete at final position.
- 5 Remove lifting springs.
- 6 Press assembly into wet concrete to final elevation.
- 7 Finish concrete around assembly.
- 8 Remove any wet concrete that may have spilled on to the plate surface.

Watch the complete installation video online in the Detectable Warning Plates section at [neenahfoundry.com](https://www.neenahfoundry.com).





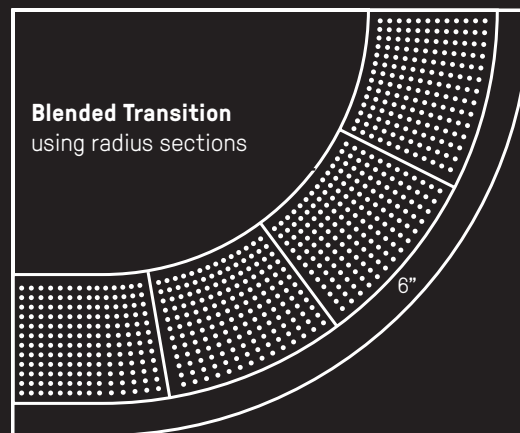
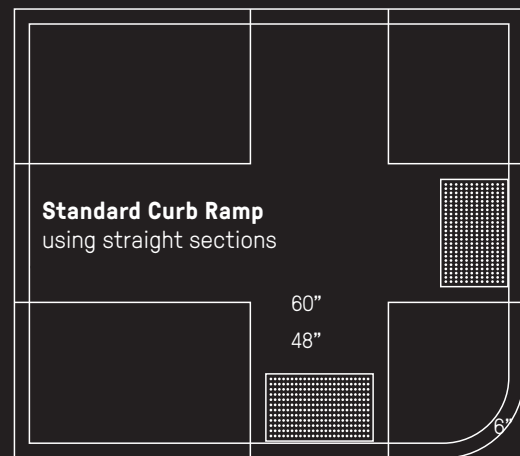

## Guideline for Accessible Right-Of-Way

The ADA and ABA have specific guidelines that refer to numerous issues concerning detectable warning. Neenah Foundry's Detectable Warning Plates help you meet these requirements.

Neenah recommends that specifiers review prevailing national, state and local guidelines to ensure full compliance.

## Suggested Specifications

### General

Detectable warnings shall be an integral part of the ramp and comply with section 4.29 of the ADA Accessibility Guidelines and section 705 of the 2010 ADA standards for accessible design.

### Dome Size

(4.29.2 and 705.1.1)

Truncated domes in detectable warning surface shall have a base diameter of 0.9 inch (23 mm) minimum and 1.4 inches (36 mm) maximum, a top diameter of 50 percent of the base diameter minimum, to 65 percent of the base diameter maximum, and a height of 0.2 inch (5.1 mm).

### Dome Spacing

(4.29.2 and 705.1.2)

Truncated domes in a detectable warning surface shall have a center-to-center spacing of 1.6 inches (41 mm) minimum and 2.4 inches (61 mm) maximum, and a base-to-base spacing of 0.65 inch (17 mm) minimum, measured between the most adjacent domes on a square grid.

### Contrast

(4.29.2 and 705.1.3)

Detectable warning surfaces shall contrast visually with adjacent walking surfaces – either light-on-dark, or dark-on-light.

### Platform Edges

(4.29.2 and 705.2)

Detectable warning surfaces at platform boarding edges shall be 24 inches (610 mm) wide and shall extend the full length of the public use areas of the platform.

### Materials

Cast gray iron conforming to ASTM A-48 class 30A minimum.

A PATTERN OF DURABILITY

## ANNOUNCING THE NEW DETECTABLE WARNING RADIUS CALCULATOR



Visit [neenahfoundry.com](https://neenahfoundry.com) to use our radius calculator.

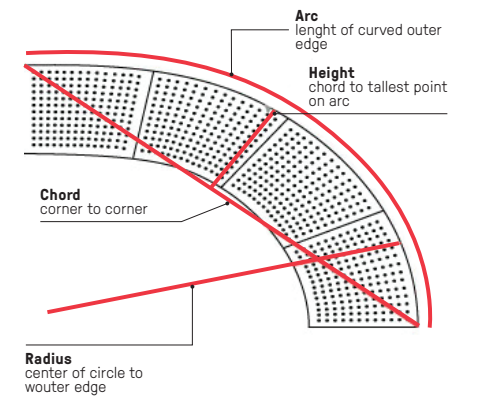



BUY AMERICAN



The American Recovery and Reinvestment Act (ARRA) of 2009 was enacted to stimulate the economy by incentivizing the use of American-made products.

By choosing Neenah cast iron products, not only are you getting the quality and durability you need while supporting American jobs, you could also be qualifying for federal funding on your project.

GO GREEN



In support of the Green Initiative, Neenah Foundry is pleased to report that our products contain a minimum of 85% recycled content in the form of a minimum of

35% consumer-generated scrap metal and minimum of 50% industrial-generated scrap metal.

**Neenah Foundry Company**

Box 729, Neenah, Wisconsin 54957-0729

Phone: 800-558-5075 // 920-725-7000

Fax: 920-729-3661

Web: [www.neenahfoundry.com](http://www.neenahfoundry.com)

**NEENAH** **IF**  
FOUNDRY

These products are to be specified and used under the guidance of qualified design professionals.